

SPINA CILINDRICA CON FILETTO INTERNO DIN/ISO 8795

DOWEL-PIN WITH INTERNAL THREAD ISO/DIN 8795

CODICE / Item no.

Z62

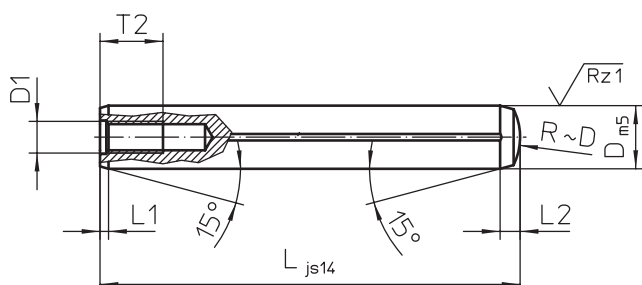

Materiale: acciaio legato da
utensili

Material: steel

Esecuzione: temprata,
rinvenuta, rettificata e lappata
con piani per sfogo aria

*Execution: hardening,
tempering, ground and lapped
with plans to air vent*

Durezza: Rc 58÷ 62

Hardness: Rc 58÷62

Esempio di ordine:

Z62 DxL

Ordering - example:

Z62 DxL

L								
	6	8	10	12	14	16	20	25
16	▪							
20	▪	▪						
24	▪	▪	▪					
28	▪	▪	▪	▪				
30		▪						
32	▪	▪	▪	▪	▪	▪		
36	▪	▪	▪					
40	▪	▪	▪	▪	▪	▪	▪	
45	▪	▪	▪	▪	▪	▪	▪	▪
50	▪	▪	▪	▪	▪	▪		▪
55	▪	▪		▪		▪	▪	
60	▪	▪	▪	▪	▪	▪	▪	▪
70		▪	▪	▪	▪	▪	▪	▪
80		▪	▪	▪	▪	▪	▪	▪
90		▪		▪			▪	▪
100		▪	▪	▪	▪	▪	▪	▪
120			▪	▪	▪	▪	▪	▪