

# FLANGE DI CENTRATURA

## LOCATING RING WITH SCREW HOLES

CODICE / Item no.

# N25

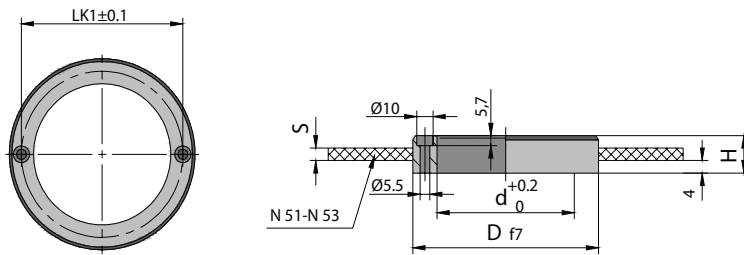

Materiale: 1.1191  
Material: 1.1191

**Esempio di ordine:**  
1 pezzo N25 Ø 125/12  
**Ordering - example:**  
1 piece N25 Ø 125/12

S	LK1	d	D	H
-				12
6	104	82	125	18
8				20
-				14
6	144	120	160	20
8				22

S	LK1	d	D	H
-	144	120	200	14
8				22
-	144	120	250	14
8				22

MISURE SPECIALI SU RICHIESTA  
SPECIAL SIZE AVAILABLE ON REQUEST

# FLANGE DI CENTRATURA

## LOCATING RING WITH SCREW HOLES

CODICE / Item no.

# N26

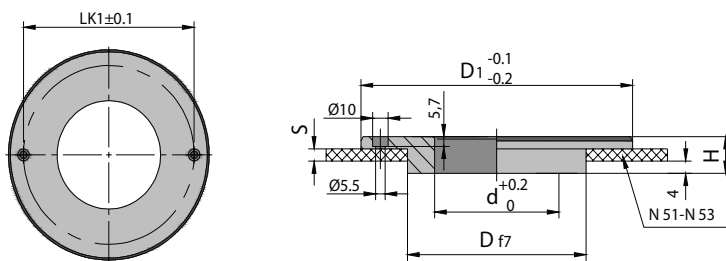

Materiale: 1.1191  
Material: 1.1191

**Esempio di ordine:**  
1 pezzo N26 Ø 60/90/18  
**Ordering - example:**  
1 piece N26 Ø 60/90/18

S	LK1	d	D1	D	H
-					18
3	75	50	60	90	18
5					26
-					12
3	98	82	110	90	18
5					20
-					12
3	104	82	120	90	18
5					20
-					12
3	104	82	125	90	18
5					20
-					12
3	104	82	160	90	18
5					20

S	LK1	d	D1	D	H
-					12
3	104	82	175	90	18
5					20
-					18
3	95	70	80	110	24
5					26
-					14
3	144	120	175	160	20
5					22
-					14
3	144	120	200	160	22
-					14
3	144	120	250	160	22

MISURE SPECIALI SU RICHIESTA  
SPECIAL SIZE AVAILABLE ON REQUEST